

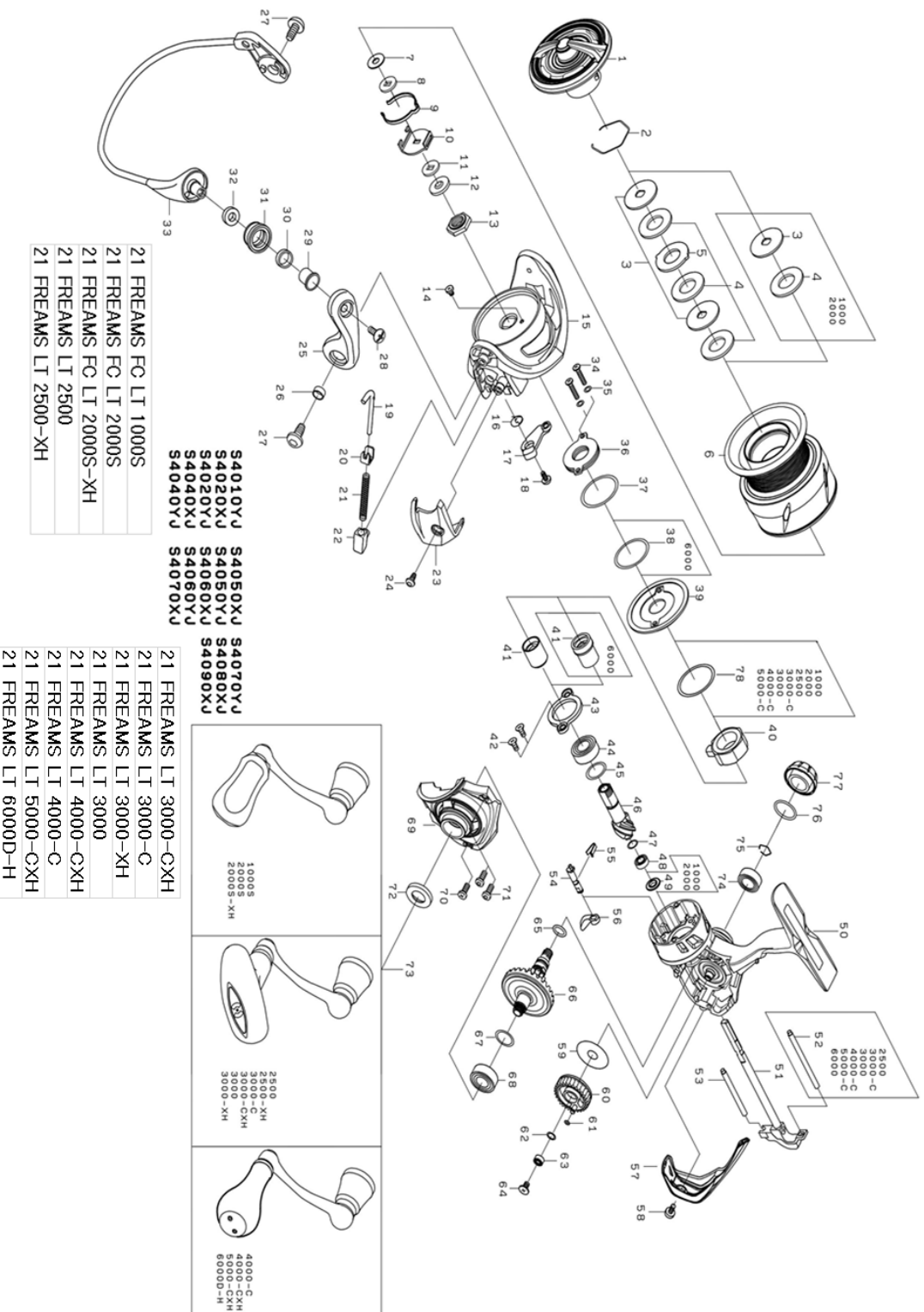

# 21 FREAMS LT 6000D-H

Feel Alive.

Please quote by part number, not key number when ordering.  
 spares@daiwaaustralia.com.au PH: (02) 8644 8644



- 21 FREAMS FC LT 1000S
- 21 FREAMS FC LT 2000S
- 21 FREAMS FC LT 2000S-XH
- 21 FREAMS LT 2500
- 21 FREAMS LT 2500-XH

- 54010YJ
- 54020XJ
- 54020YJ
- 54040XJ
- 54040YJ
- 54050XJ
- 54050YJ
- 54060XJ
- 54060YJ
- 54070XJ
- 54070YJ
- 54080XJ
- 54090XJ

- 21 FREAMS LT 3000-CXH
- 21 FREAMS LT 3000-C
- 21 FREAMS LT 3000-XH
- 21 FREAMS LT 3000
- 21 FREAMS LT 4000-CXH
- 21 FREAMS LT 4000-C
- 21 FREAMS LT 5000-CXH
- 21 FREAMS LT 6000D-H

| REEL NAME            | MGFT CODE | KEY NO | PARTS CODE | DESCRIPTION                  |
|----------------------|-----------|--------|------------|------------------------------|
| 21 FREAMS LT 6000D-H |           | 1      | 6Q364201   | DRAG KNOB                    |
| 21 FREAMS LT 6000D-H |           | 2      | 61704101   | DRAG WASHER RETAINER         |
| 21 FREAMS LT 6000D-H |           | 3      | 6J577501   | KEY WASHER                   |
| 21 FREAMS LT 6000D-H |           | 4      | 6J577201   | DRAG WASHER                  |
| 21 FREAMS LT 6000D-H |           | 5      | 6Q377601   | EARED WASHER                 |
| 21 FREAMS LT 6000D-H |           | 6      | 6Q706901   | SPOOL ASSY (2-6)             |
| 21 FREAMS LT 6000D-H |           | 7      | 6F050104   | SPOOL WASHER (A)             |
| 21 FREAMS LT 6000D-H |           | 8      | 6Q363801   | SPOOL WASHER (B)             |
| 21 FREAMS LT 6000D-H |           | 9      | 6H416101   | CLICK LEAF SPRING            |
| 21 FREAMS LT 6000D-H |           | 10     | 6M021501   | CLICK SPRING HOLDER          |
| 21 FREAMS LT 6000D-H |           | 11     | 6Q377501   | SPOOL WASHER (C)             |
| 21 FREAMS LT 6000D-H |           | 12     | 6H995201   | ROTOR NUT PACKING            |
| 21 FREAMS LT 6000D-H |           | 13     | 6Q363701   | ROTOR NUT                    |
| 21 FREAMS LT 6000D-H |           | 14     | 6H022701   | ROTOR NUT SCREW              |
| 21 FREAMS LT 6000D-H |           | 15     | 6Q134535   | ROTOR                        |
| 21 FREAMS LT 6000D-H |           | 16     | 6H413601   | BAIL TRIP LEVER SPRING       |
| 21 FREAMS LT 6000D-H |           | 17     | 6Q134601   | BAIL TRIP LEVER              |
| 21 FREAMS LT 6000D-H |           | 18     | 6H417701   | BAIL TRIP LEVER SCREW        |
| 21 FREAMS LT 6000D-H |           | 19     | 6Q134801   | ARM LEVER SHAFT              |
| 21 FREAMS LT 6000D-H |           | 20     | 6H576101   | ARM LEVER SHAFT PLATE        |
| 21 FREAMS LT 6000D-H |           | 21     | 6H640701   | ARM LEVER SPRING             |
| 21 FREAMS LT 6000D-H |           | 22     | 6Q121501   | ARM LEVER SPRING HOLDER      |
| 21 FREAMS LT 6000D-H |           | 23     | 6Q134901   | ARM LEVER COVER              |
| 21 FREAMS LT 6000D-H |           | 24     | 6Q342901   | ARM LEVER COVER SCREW        |
| 21 FREAMS LT 6000D-H |           | 25     | 6Q121623   | ARM LEVER                    |
| 21 FREAMS LT 6000D-H |           | 26     | 6Q121701   | ARM LEVER SCREW COLLAR       |
| 21 FREAMS LT 6000D-H |           | 27     | 6Q343401   | ARM LEVER SCREW              |
| 21 FREAMS LT 6000D-H |           | 28     | 6G195602   | ROLLER SCREW                 |
| 21 FREAMS LT 6000D-H |           | 29     | 6G195501   | ROLLER COLLAR (A)            |
| 21 FREAMS LT 6000D-H |           | 30     | 6G220701   | ROLLER COLLAR (B)            |
| 21 FREAMS LT 6000D-H |           | 31     | 6J089902   | LINE ROLLER                  |
| 21 FREAMS LT 6000D-H |           | 32     | 6Q203401   | ROLLER COLLAR (C)            |
| 21 FREAMS LT 6000D-H |           | 33     | 6Q135001   | BAIL                         |
| 21 FREAMS LT 6000D-H |           | 34     | 6G837101   | MAGSEALED PLATE SCREW        |
| 21 FREAMS LT 6000D-H |           | 35     | 63754102   | MAGSEALED PLATE SCREW WASHER |
| 21 FREAMS LT 6000D-H |           | 36     | 6J289301   | MAGSEALED PLATE              |
| 21 FREAMS LT 6000D-H |           | 37     | 6J212901   | MAGSEALED O RING             |
| 21 FREAMS LT 6000D-H |           | 38     | 6J238801   | MAGSEALED WASHER             |
| 21 FREAMS LT 6000D-H |           | 39     | 6Q363501   | MAGSEALED CAP                |
| 21 FREAMS LT 6000D-H |           | 40     | 6J309101   | ONEWAY CLUTCH                |
| 21 FREAMS LT 6000D-H |           | 41     | 6J690501   | CLUTCH RING                  |
| 21 FREAMS LT 6000D-H |           | 42     | 6Q195701   | PINION BEARING PLATE SCREW   |
| 21 FREAMS LT 6000D-H |           | 43     | 6Q205901   | PINION BEARING PLATE         |
| 21 FREAMS LT 6000D-H |           | 44     | 66354801   | PINION BALL BEARING (A)      |
| 21 FREAMS LT 6000D-H |           | 45     | 63712824   | PINION BEARING WASHER        |
| 21 FREAMS LT 6000D-H |           | 46     | 6Q366401   | PINION GEAR                  |
| 21 FREAMS LT 6000D-H |           | 47     | 6G572501   | PINION SPRING WASHER         |
| 21 FREAMS LT 6000D-H |           | 48     | 6G467106   | PINION BALL BEARING (B)      |
| 21 FREAMS LT 6000D-H |           | 49     | -----      | ---                          |
| 21 FREAMS LT 6000D-H |           | 50     | 6Q705301   | BODY                         |
| 21 FREAMS LT 6000D-H |           | 51     | 6Q362601   | MAIN SHAFT                   |
| 21 FREAMS LT 6000D-H |           | 52     | 6Q126303   | OSCILLATING POST (A)         |
| 21 FREAMS LT 6000D-H |           | 53     | 6Q119103   | OSCILLATING POST (B)         |
| 21 FREAMS LT 6000D-H |           | 54     | 6Q133401   | ANTI REVERSE CAM             |



|  |  |  |  |  |
|--|--|--|--|--|
|  |  |  |  |  |
|  |  |  |  |  |
|  |  |  |  |  |
|  |  |  |  |  |
|  |  |  |  |  |